

UPVC

PIPES & FITTINGS
American Standard

مواسير و وصلات
طبقا للمواصفات الامريكية

UPVC Pipes According to ASTM D - 1785 (Sch - 40) (Sch - 80)
 مواسير UPVC طبقا للمواصفة الامريكية

Size Inch	SCHEDULE (40)						SCHEDULE (80)			
	Outside diameter (MM)		Thickness (MM)		Weight kg/meter	Pressure rating bar	Thickness (MM)		Weight kg/meter	Pressure rating bar
	Min	Max	Min	Max			Min	Max		
1/2	21.2	21.2	2.8	3.3	0.24	41.4	3.7	4.2	0.31	58.6
3/4	26.6	26.9	2.9	3.4	0.33	33.1	3.9	4.4	0.41	47.6
1	33.4	33.7	3.4	3.9	0.48	31	4.6	5.1	0.6	43.4
1 1/4	42.1	42.4	3.6	4.1	0.65	25.5	4.9	5.4	0.48	35.9
1 1/2	48.1	48.4	3.7	4.2	0.77	22.8	5.1	5.7	1.03	32.4
2	60.2	60.5	3.9	4.4	1.04	19.3	5.5	6.2	1.41	27.6
3	88.7	89.1	5.5	6.2	2.14	17.9	7.6	8.5	2.88	25.5
4	114.1	114.5	6	6.7	3.05	15.2	8.6	9.6	4.22	22.1
6	168	168.5	7.1	8	5.37	12.4	11	12.3	8.05	19.3

UPVC Pipes According to ASTM D2241 (SDR)
 مواسير UPVC طبقا للمواصفة الامريكية

Size Inch	O.D MIM.	SDR 64 PSI 63 BAR 4.3		SDR 64 PSI 100 BAR 6.9		SDR 32.5 PSI 125 BAR 8.6		SDR 26 PSI 160 BAR 11		SDR 21 PSI 200 BAR 13.8		SDR 17 PSI 250 BAR 17.8		SDR 13.5 PSI 315 BAR 21.7	
		W.T	KG/M	W.T	KG/M	W.T	KG/M	W.T	KG/M	W.T	KG/M	W.T	KG/M	W.T	KG/M
1/2	21.34													1.6	0.161
3/4	26.67									1.5	0.195	1.6	0.205	2.0	0.245
1	33.4							1.5	0.247	1.6	0.260	2	0.313	2.5	0.376
1 1/4	42.16					1.5	0.31	1.6	0.333	2.0	0.401	2.5	0.484	3.1	0.580
1 1/2	48.26					1.5	0.363	1.9	0.442	2.3	0.502	2.9	0.634	3.6	0.763
2	60.33					1.9	0.558	2.3	0.657	2.9	0.804	3.6	0.970	4.5	1.180
2 1/2	73.03					2.2	0.772	2.8	0.952	3.5	1.160	4.3	1.390	5.4	1.730
3	88.9					2.7	1.13	3.4	1.390	4.2	1.680	5.2	2.050	6.6	2.560
4	114.3	1.8	1.03	2.8	1.51	3.5	1.85	4.4	2.280	5.4	2.790	6.7	3.390	8.5	4.230
6	168.28	2.6	2.10	4.1	3.18	5.2	3.99	6.5	4.970	8	6.060	9.9	7.390	12.5	9.160

Elbow 87.5° with Access / 87.5° كوع باب

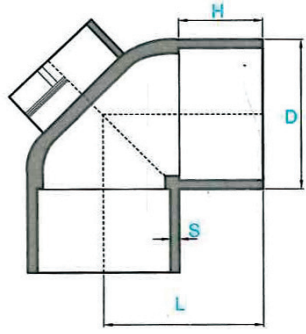

Item NO.	Inch	D m m	S m m	H m m	L m m
1	2	68	3.9	38	72
2	3	99.7	5.5	48	102
3	4	126.1	6	51	120
4	6	182.2	7.1	76	168

Elbow 87.5°/87.5° كوع

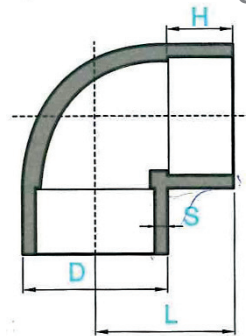

Item NO.	Inch	D m m	S m m	H m m	L m m
1	1	40.2	3.4	22	42
2	1.5	55.5	3.7	31	60
3	2	68	3.9	38	72
4	3	99.7	5.5	48	102
5	4	126.1	6	51	120
6	6	182.2	7.1	76	168

Elbow 45°/45° كوع

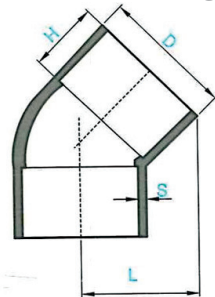

Item NO.	Inch	D m m	S m m	H m m	L m m
1	1	40.2	3.4	22	40
2	1.5	55.5	3.7	31	58
3	2	68	3.9	38	74
4	3	99.7	5.5	48	85
5	4	126.1	6	51	103
6	6	182.2	7.1	76	140

مشترك 87.5° / Tee 87.5°

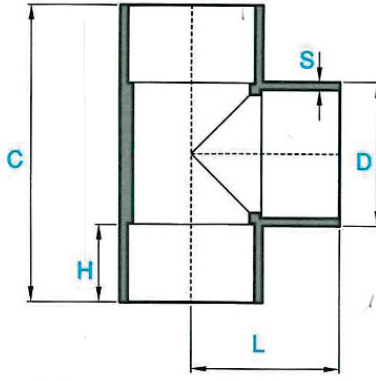

Item NO.	Inch	D m m	S m m	H m m	L m m	C m m
1	2	68	3.9	38	94	157
2		126.1	6	51	127	235

مشترك 87.5° / Tee 87.5°

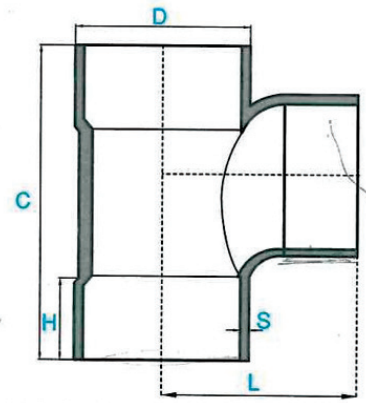

Item NO.	Inch	D m m	S m m	H m m	L m m	C m m
1	1	40.2	3.4	22	39	77.5
2	1.5	55.5	3.7	31	57	116
3	3	99.7	5.5	48	86.50	173
4	6	182.2	7.1	76	165	330

جلبة لصق / Register Coupling

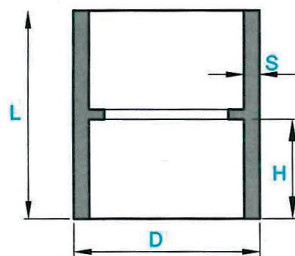

Item NO.	Inch	D m m	S m m	H m m	L m m
1	1	40.2	3.4	22	42
2	1.5	55.5	3.7	31	66
3	2	68	3.9	38	80
4	3	99.7	5.5	48	101
5	4	126.1	6	51	108
6	6	182.2	7.1	76	151

Cross Tee 87.5° / 87.5° مشترك صليبة

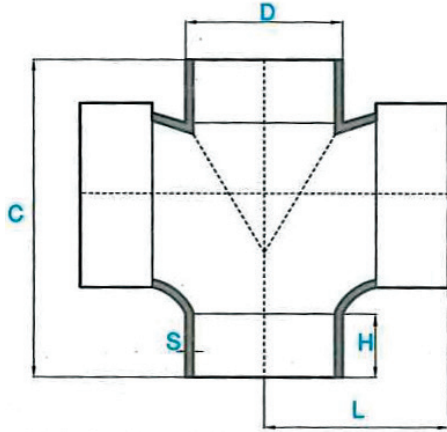

Item NO.	Inch	D m m	S m m	H m m	C m m	L m m
1	4	126.1	6	51	257	149

Tee with access 87.5° / 87.5° مشترك باب

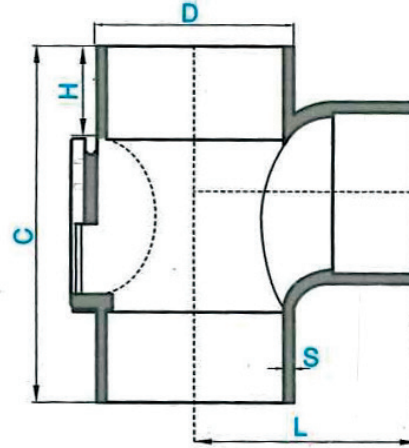

Item NO.	Inch	D m m	S m m	H m m	L m m	C m m
1	3	99.7	5.5	48	86.5	173.0
2	6	182.2	7.1	76	165	330.0

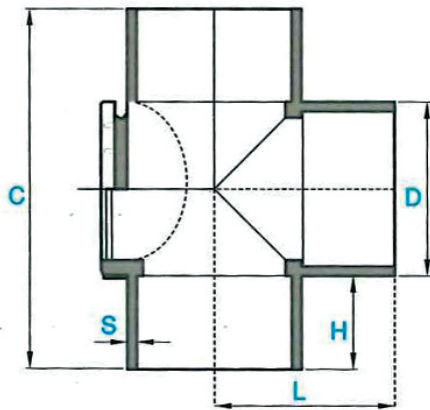

Item NO.	Inch	D m m	S m m	H m m	L m m	C m m
1	2	68	3.9	38	94	157
2	4	126.1	6	51	127	235

مشترك مسلوب 87.5° / 87.5° Reducing Tee

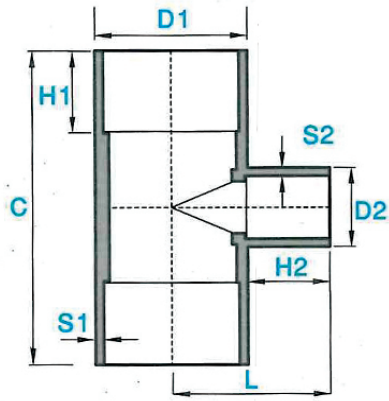

Item NO.	Inch	D1 mm	D2 mm	S1 mm	S2 mm	H1 mm	H2 mm	L mm	C mm
1	4-3	126.1	99.7	6	5.5	51	48	96	200
	6-4	182.2	126	7.1	6	76	51	169	320

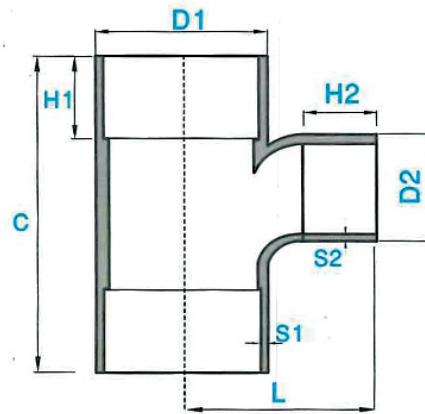

Item NO.	Inch	D1 mm	D2 mm	S1 mm	S2 mm	H1 mm	H2 mm	L mm	C mm
1	3-2	99.7	68	5.5	3.9	48	38	111	180
2	4-2	126.1	68	6	3.9	51	38	122	215

مشترك مسلوب واي 45° / 45° Reducing Tee Wye

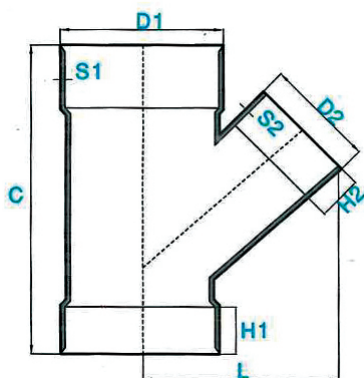

Item NO.	Inch	D1 mm	D2 mm	S1 mm	S2 mm	H1 mm	H2 mm	L mm	C mm
1	6-4	182.2	126.1	7.1	6	76	51	230	350
2	4-2	126.1	68	6	3.9	51	38	125	240

مشترك مسلوب باب 87.5 / 87.5 Reducing Tee with access

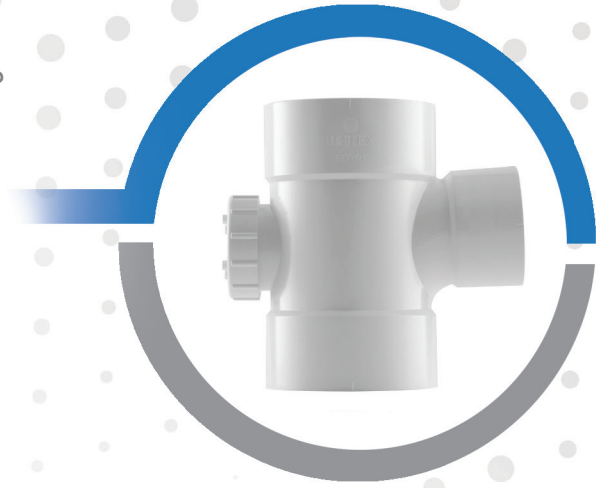
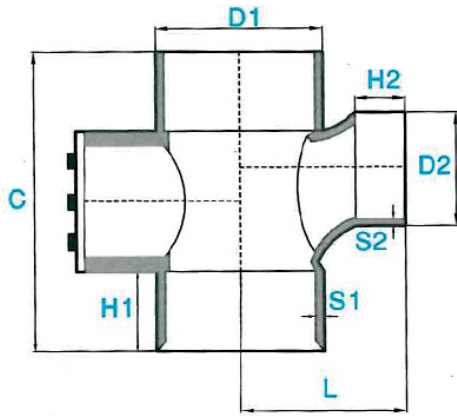

Item NO.	Inch	D1 mm	D2 mm	S1 mm	S2 mm	H1 mm	H2 mm	L mm	C mm
1	4-3	126.1	99.7	6	5.5	51	48	96	200
	6-4	182.2	126	7.1	6	76	51	169	320

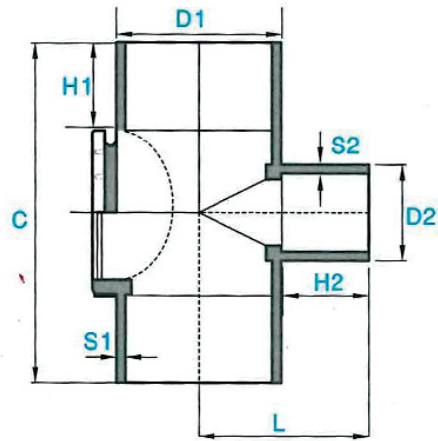
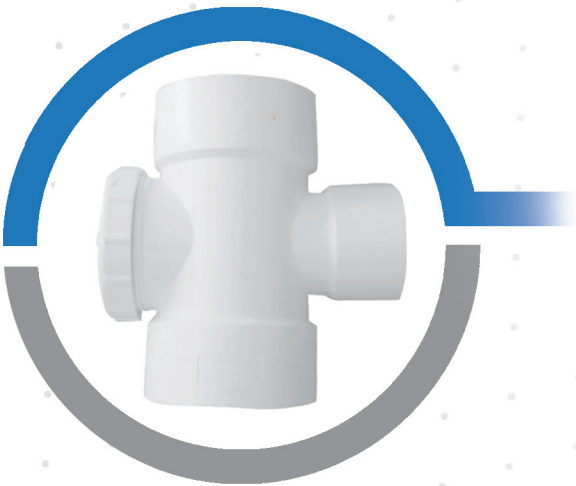

Item NO.	Inch	D1 mm	D2 mm	S1 mm	S2 mm	H1 mm	H2 mm	L mm	C mm
1	3-2	99.7	68	5.5	3.9	48	38	111	180
2	4-2	126.1	68	6	3.9	51	38	122	215

مشترك واي 45° 45 Reducing Tee Wye 45°

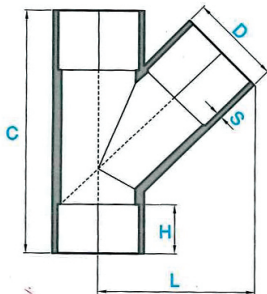

Item NO.	Inch	D mm	S mm	H mm	L mm	C mm
1	1	40.2	3.4	22	66	112
2	1.5	55.5	3.7	31	85	141
3	2	68	3.9	38	110	170
4	3	99.7	5.5	48	140	173
5	4	126.1	6	51	195	260
6	6	182.2	7.1	76	270	330

Floor trap 7 cm / بيبة 7 سم

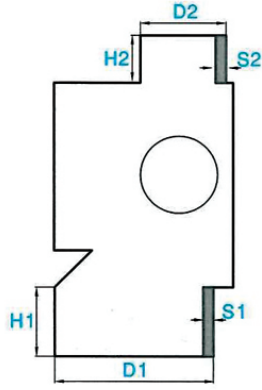

Item NO.	Inch	D1 mm	D2 mm	S1 mm	S2 mm	H1 mm	H2 mm
1	2 x 1.5	68	55.5	3.9	3.7	38	31

Air Vent / هوية

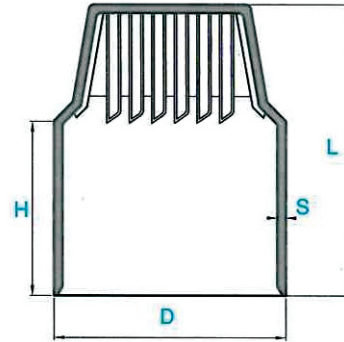

Item NO.	Inch	D1 mm	D2 mm	S1 mm	S2 mm
1	3	99.7	5.5	48	114
2	4	126.1	6	51	160

Floor trap 10 cm / بيبة 10 سم

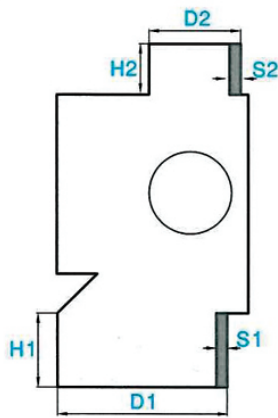

Item NO.	Inch	D1 mm	D2 mm	S1 mm	S2 mm	H1 mm	H2 mm
1	3 x 1.5	99.7	55.5	5.5	3.7	48.0	31
2	3 x 2	99.7	68.0	5.5	3.9	48.0	38
3	2 x 1.5	68	55.5	3.9	3.7	38	31
4	2 x 2	68	68	3.9	3.9	38	38

غرفة تفتيش بلاستيك / Gully Trap

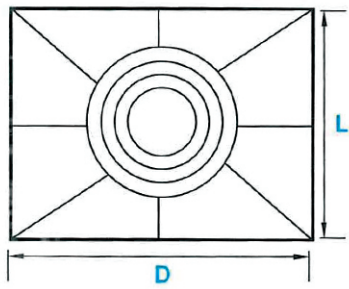

Item NO.	D m m	L m m
1	300	300

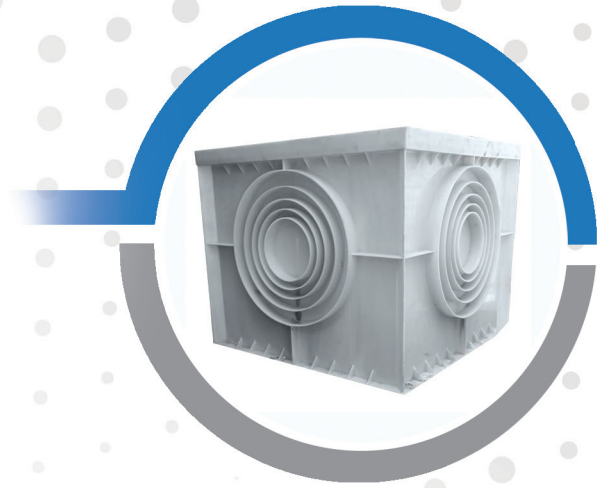

جرجوري / Roof Drains

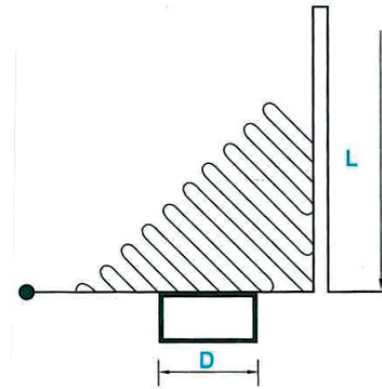

Item NO.	Normal size	D m m	L m m
1	50	75	115

جرجوري / Roof Drains

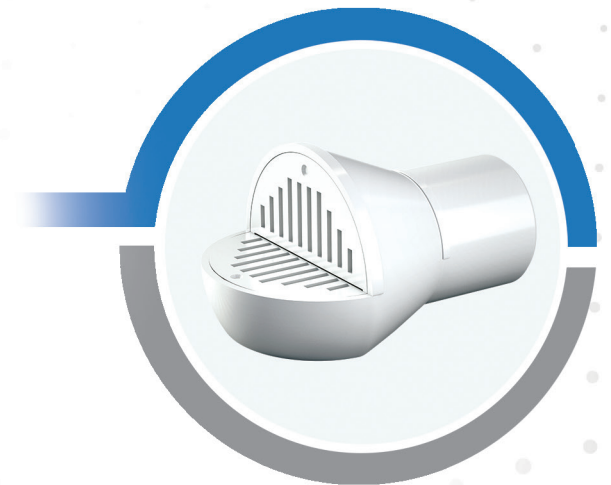
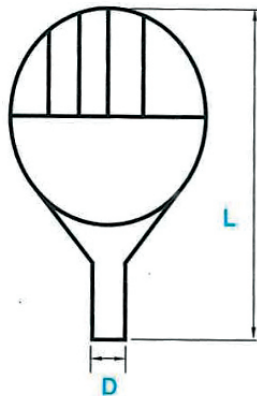

Item NO.	Normal size	D m m	L m m
1	3	75	265
2	4	110	300

P Trap Syphon / كوع ريحة سيفون

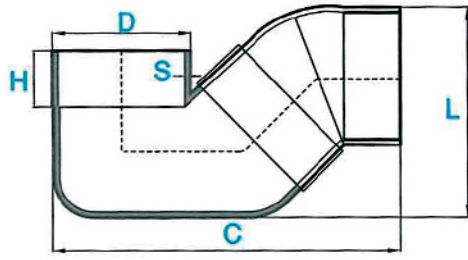

Item NO.	inch	D m m	S m m	H m m	C m m	L m m
1	4	126.1	6	51	310	200

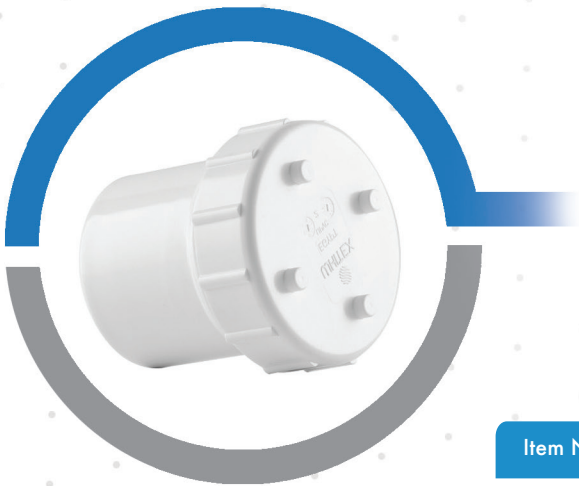

Clean Out / طبة تسليك

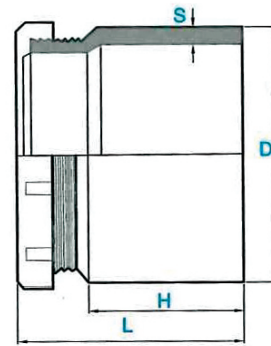

Item NO.	inch	D m m	S m m	H m m	L m m
1	1.5	48	3.7	31	65
2	2	60	3.9	38	70
3	4	114.3	6	51	94

Reducing Bush / بوش

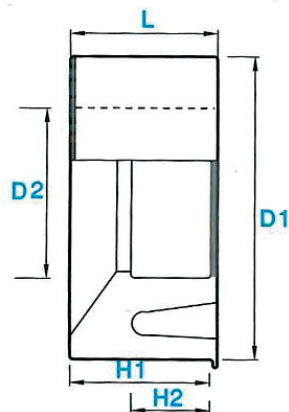

Item NO.	inch	D1 m m	D2 m m	H1 m m	H2 m m	L m m
1	1 - 1.5	48.1	33.4	31	22	46
2	2 - 1.5	60.2	48.1	38	31	32
3	3 - 2	88.7	60.2	48	38	46
4	4 - 2	114.1	60.2	51	38	61
5	4 - 3	114.1	88.7	51	48	60
6	6 - 4	168	114.1	76	51	78

Threaded Elbow Female / كوع بانيو بسن

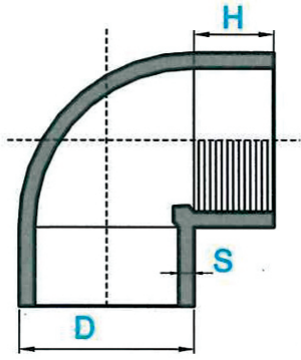

Item NO.	Normal size (inch)	D mm	S mm	H mm
1	1.5	55.5	3.7	31

Threaded Coupling - Female / جلبة بانيو بسن

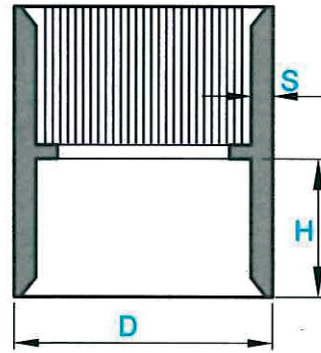

Item NO.	Normal size (inch)	D mm	S mm	H mm
1	1.5	61	6.5	27

End Cap / طبقة نهاية خط

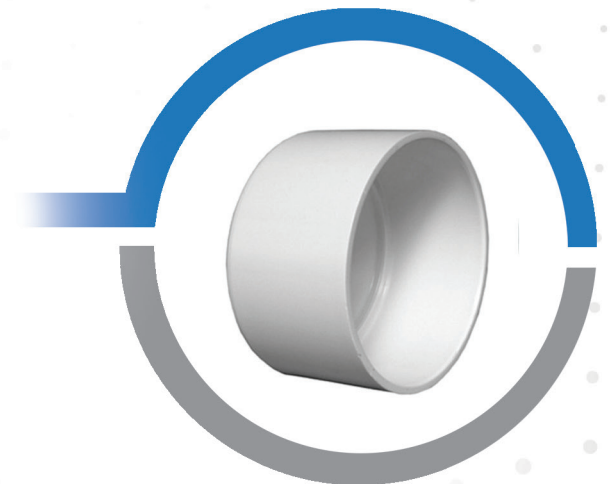
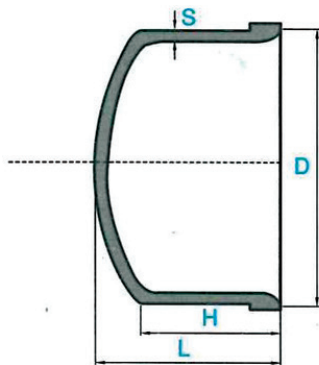

Item NO.	Normal size (inch)	D mm	S mm	H mm	L mm
1	4	126.1	6.0	51	69